



# Sobering Center

Trina Wheeldon CHES  
Adapt Sobering Center Manger

# What is a Sobering Center?

A Sobering Center is:

a facility in which individuals will receive:

- a safe place to stay
- during periods of acute intoxication
- for at least 4 and as many as 23 hours

We expect the length of stay to be 4 to 12 hours in most cases.

# Purpose

Often confused with Detox

Detox is a medical service to safely help a person through the transition away from a substance while minimizing withdrawal symptoms

Sobering is about public safety and the safety of the people in the sobering center

Sobering is for people who are actively intoxicated and may be a danger to themselves or others

# Types of Sobering Centers

- Models
  - Low Barrier Shelter
    - Many people in one or several rooms
    - Some have cots, others have blankets
  - Holding Rooms
    - Individuals in their own rooms or cells
    - Could be locked cells or unlocked rooms

**\*\* Ours is the Holding Room Style\*\***

# Low Barrier Shelter



# Holding Room



# Location

- This is adjacent to our current Detox and Adult Residential treatment program Crossroads
- Little or no impact on the surrounding neighborhood as people in the Sobering Center will be transported back to where they were picked up or home
- **Address – 251 NE Patterson Street Roseburg OR**

# Location





# Plans

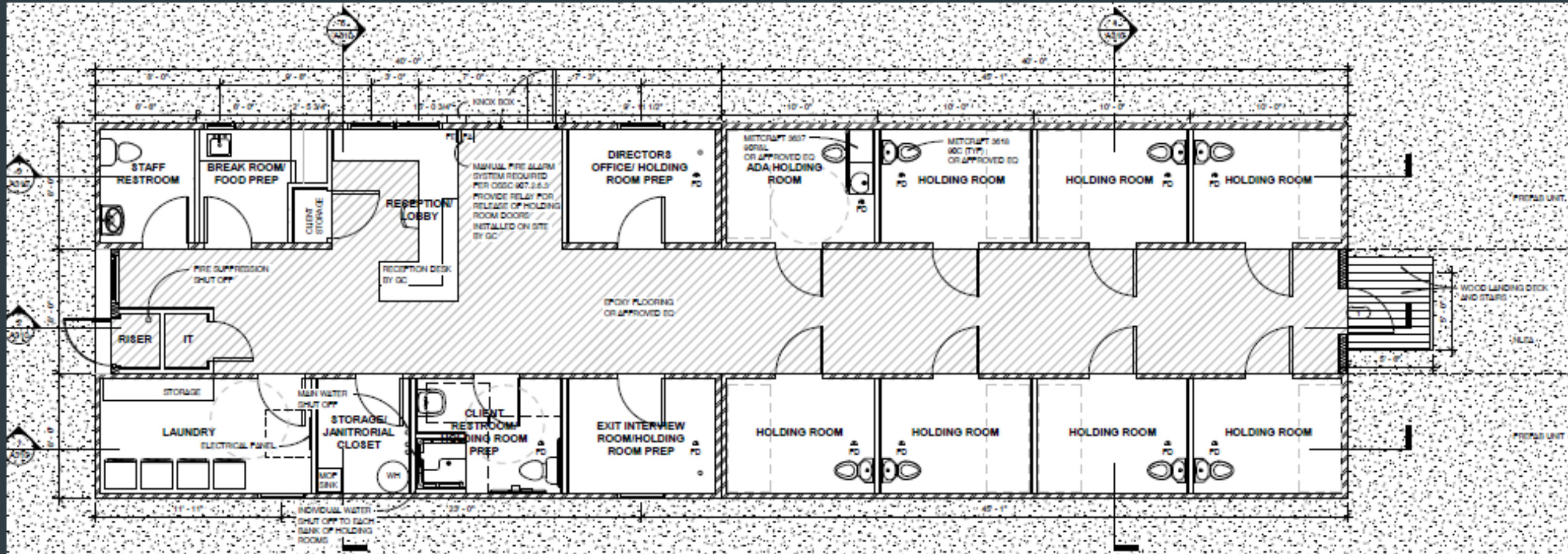

# Why Adapt and Why Now

- Sobering is not treatment and is not billable
  - it is a resource that helps
    - the community
    - those who use it
- Staff are paraprofessionals
  - Use medically developed protocols
  - Monitor the people in the sobering center
- Goal is to provide:
  - Safe space
  - Without Judgement
  - Where people can regain some control
- Engage those who have an interest in treatment and recovery

# Community Support

- As mentioned previously, this service is not billable, so both the startup and operations cost have to be paid through other means
- The Douglas County Commissioners
- LPSCC (Local Public Safety Coordinating Council)
- City of Roseburg
- City of Sutherlin
- City of Myrtle Creek
- Umpqua Health Alliance
- Cow Creek Tribe
- Redeemers Church
- have all pledged support

# Other Support

- Adapt has received support from The state with two grants that supported the start up of the Sobering Center. Also there has been a major donation by a local couple (Dave and Kelley Trincherro) wanting to support this work.
- Ongoing smaller grant opportunities and private donations also play a vital role in program & services growth.

# Open for Services August 13<sup>th</sup>, 2021



# Admissions Process

At this time all Clients will need to be brought to Sobering Center through Local Law Enforcement and need to pass the screening process to make sure they are a good fit for the Sobering Center.

Intoxicated adults are referred and transported to the Sobering Center only by law enforcement. It is not a place where family or friends can bring someone to sober up.

**Exclusion Criteria**

- BAL > 3.0
- Suicidal / Homicidal
- Unable to Meet Basic Needs
- Under 18 years of age
- Insulin-Dependent Diabetic
- Combative
- Wounds Requiring Repair
- Seizures
- Chest Pain / Shortness of Breath

Questions? Call 541-957-3797

# Admissions Process

- Law Enforcement Officers will Call the Sobering Center when they have contact with an intoxicated individual that is unable to care for themselves or is unsafe to be left unattended in the community.

**Phone # 541-957-3797**

- Once cleared with the Sobering Center Law Enforcement will transport to the Sobering Center
  - When Law Enforcement Arrives on-site the Sobering Technician will open the gate & door and start the intake process with the Officer present.
- After Intake is complete Law Enforcement and the Sobering Technician will escort the individual to a room.
  - The intake process on average takes 10-15 Mins.

# Staffing

- The Sobering Center will have 1 Sobering Technician on Duty at all times
- Sobering Technicians will be an Entry Level Position , with a formal onsite training pathway for online and in person trainings. We are hiring for a heart to help people in our community. We will have a total of 6 staff members, 4 FT & 2 PT.
- The Sobering Center has 1 FT dedicated Peer Mentor to help connect the Clients to needed Community Services.



# Client Services

During the Clients stay at the Sobering Center , Sobering Technicians will offer/provide the following services :

- Check Vitals & BAL
- Monitor for Safety every 15 Min.
- Recheck Vitals per Vital Signs Matrix
- Offer Client Food & Drink
- Offer Use of Shower & Personal Hygiene Items
- Offer to Wash the Clients Laundry and/or Provide Clean Clothing
- Make Referrals to Community Programs & Services
- Arrange a Safe Ride Home



# Thank you

If you would be interested in a Virtual Tour or have Questions,  
Comments or Concerns Please Contact :

Trina Wheeldon  
Sobering Center Manager  
[trinaw@adaptoregon.org](mailto:trinaw@adaptoregon.org)  
541-252-3811